

**STANDARD CLINICAL CONTAINERS:  
WITH LOCKABLE & FOOT OPERATED PEDAL POST™ OPTIONS**



**EASY HANDLING  
ROBUST PRACTICAL DESIGN  
MULTIPLE APPLICATIONS**

**Large waste solutions**

- Available in 70 litre and 110 litre
- Moulded handles
- Multiple purpose container



**Small waste solutions**

- Available in 35 litre and 50 litre
- Optional locking bar for easy handling
- Compact shape



**Pedal post**

- Optional pedal post for hands free sanitary use
- Industrial grade foot pedal
- Lightweight
- Tight fitting overlapping lid with locking handle
- Easily manoeuvred with optional castors
- Colour coded for clinical and other waste streams
- Eliminates risks of infection and contamination
- Available in green and yellow



# STANDARD CLINICAL CONTAINERS

## Material

- **Polymer components:**
  - Injection moulded from specially designed HDPE
  - Resistant to decay, frost, heat and chemicals
  - Special UV-stabilisation provides excellent ageing characteristics
- Corrosion resistant metal components
- **Long service life:**
  - High quality materials
  - Most advanced manufacturing processes
  - Withstands exposure to high mechanical stress levels
- **Recycling:**
  - All container parts are recyclable

## Advantages

- Assists with reduction in waste costs
- **Easy handling:**
  - Practical moulded handles
  - Hinged lid
  - Grip rail
  - Lightweight
  - Space saving
  - Easy and hygienic to empty

## Imprints and markings

- Manufacturer, year of manufacture, material
- Individual markings with imprints or adhesive labels are available on request\*

## Colours

- Standard colours
  - 35 litre and 50 litre: Green, Yellow and Purple
  - 70 litre and 110 litre: Dark Grey
- Special colours are available on request\*
- All additives are cadmium free and environmentally friendly

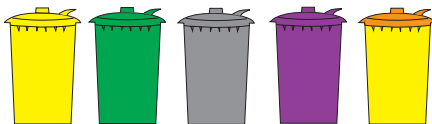

SULO MGB Australia Pty Ltd  
123 Wisemans Ferry Road  
Somersby NSW 2250  
**Australia**  
Tel: +61 (0) 2 - 4348 8188  
Fax: +61 (0) 2 - 4348 8128  
Internet: www.sulo.com.au  
E-mail: info@sulo.com.au

SULO – Queensland Office  
11 Argon Street  
Sumner Park QLD 4074  
**Australia**  
Tel: +61 (0) 7 - 3725 5000  
Fax: +61 (0) 7 - 3725 5099

## Dimensions - Weights - Standards

Nominal Volume	35ltr	50ltr	70ltr	110ltr
Net weight	2.4kg	3.1kg	4.2kg	6.2kg
Permitted total weight (To be used with automatic lifter)	20kg	30kg	40kg	60kg

Measurements to be used as a guide only, variations may occur

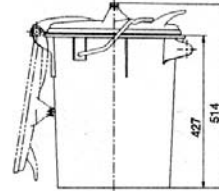

35L

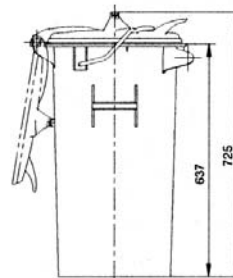
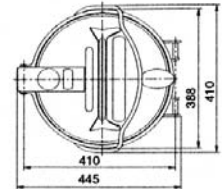

50L

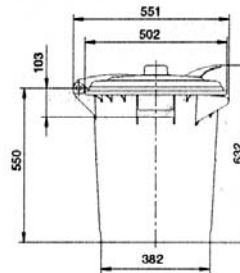
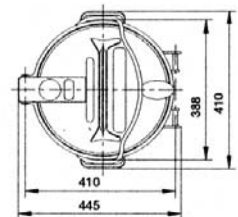

70L

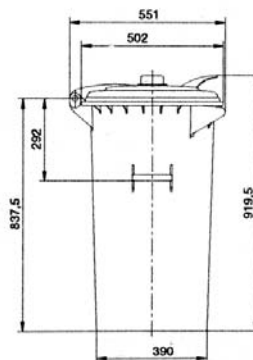
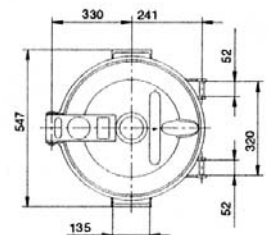

110L

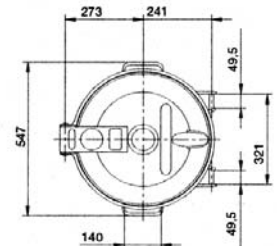

Note: Certification and Quality Marks depicted in this brochure are registered to SULO Umwelttechnik GmbH & Co. KG

SULO – Victorian Office  
1950 Hume Hwy  
Campbellfield VIC 3061  
**Australia**  
Tel: +61 (0) 3 - 9357 7320  
Fax: +61 (0) 3 - 9357 7340

SULO - New Zealand  
PO Box 58 962  
Greenmount, Manukau City 2141  
**New Zealand**  
Tel: +64 9 273 6870  
Fax: +64 9 273 8483